

here are Area of Interest layers switched off. There may be Area of Interest polygons in this view which you cannot see.

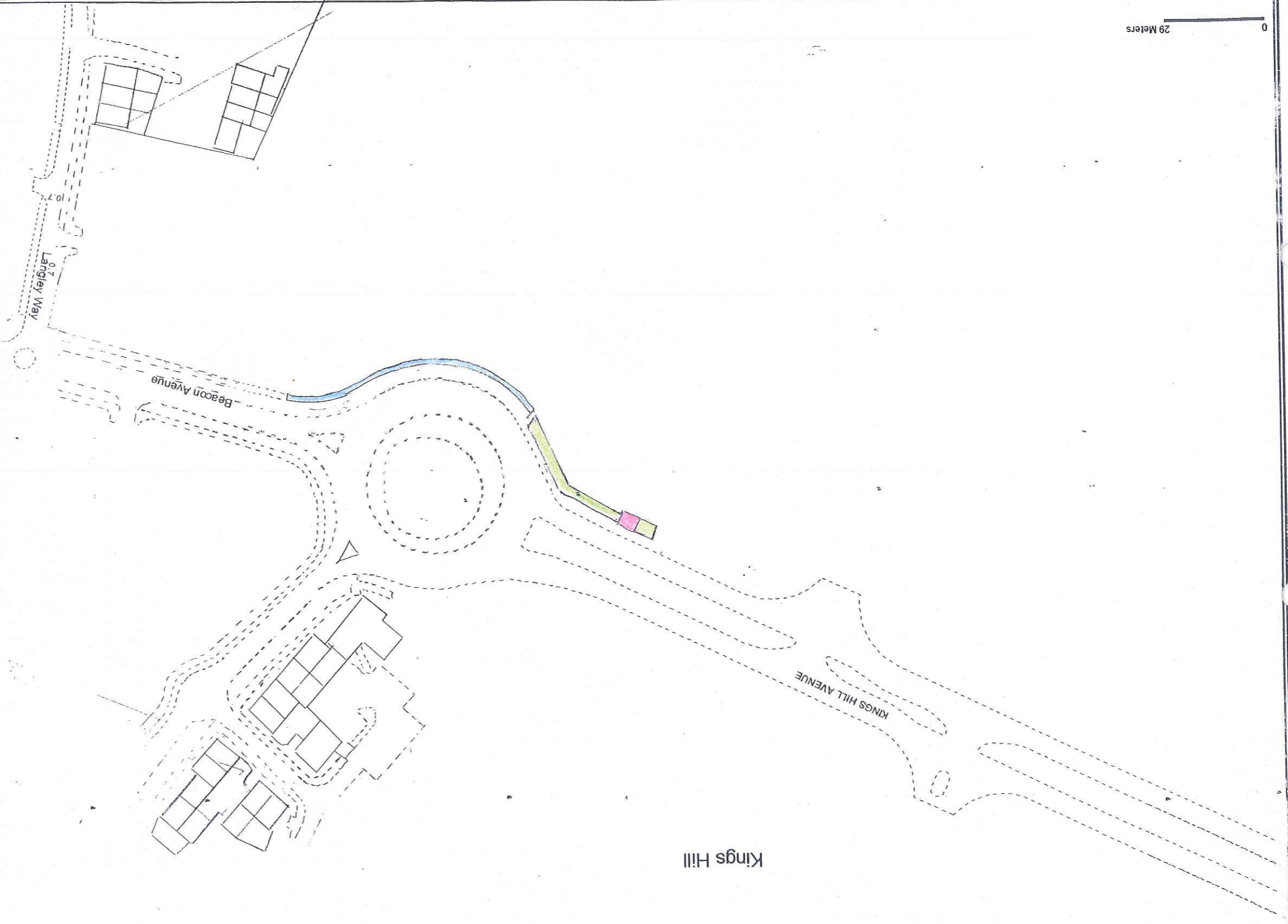

Paul Lewis
1652



Address:	Kent County Council Sessions House		
Landowner:	Liberty Property Trust UK Ltd Rouse Kent (Residential) Ltd		
Tenant:			
Drawn by:	Kim Miller	MP	7.7
Date:	25-Nov-09	LP	194M
Scale:	1:500		
O.S Ref:	TQ6855		
Cost Code:	E801 68181		
Project Type:	Connections		
Project No:	205204		

This plan shows only those pipes owned by Southern Gas Networks Ltd in its role as a Licensed Public Gas Transporter (PGT). Gas pipes owned by other PGTs and also privately owned may be present in this area. Information with regard to such pipes should be obtained from the owners. The information shown on this plan is given without obligation, or warranty, the accuracy thereof cannot be guaranteed. Service pipes, valves, syphons, stub connections, etc., are not shown but their presence should be anticipated. No liability of any kind whatsoever is accepted by Southern Gas Networks Ltd, its agents or servants for any error or omission. Safe digging practices, in accordance with HS(G)47, must be used to verify and establish the actual position of mains, pipes, services and other apparatus on site before any mechanical plant is used. It is your responsibility to ensure that this information is provided to all persons (either direct labour or contractors) working for you on or near gas apparatus. The information included on this plan should not be referred to beyond a period of 28 days from the date of issue.